

# Soils Map

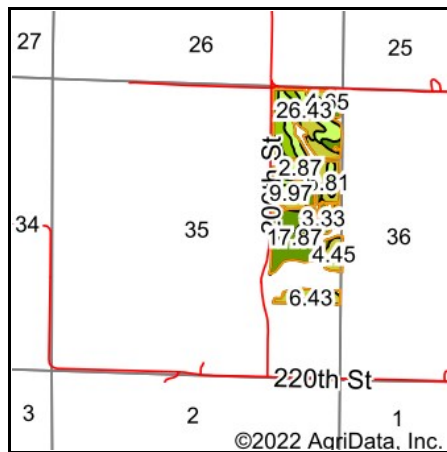

Soils data provided by USDA and NRCS.



State: **Iowa**  
 County: **Ringgold**  
 Location: **35-69N-30W**  
 Township: **Washington**  
 Acres: **82.81**  
 Date: **7/14/2022**



Area Symbol: IA159, Soil Area Version: 27

Code	Soil Description	Acres	Percent of field	CSR2 Legend	Non-Irr Class *c	CSR2**	CSR
S220	Nodaway silt loam, heavy till, 0 to 2 percent slopes, occasionally flooded	14.29	17.3%		IIw	77	
S993D2	Gara-Armstrong complex, 9 to 14 percent slopes, moderately eroded	12.01	14.5%		IVe	32	
94D2	Mystic-Caleb complex, 9 to 14 percent slopes, moderately eroded	11.55	13.9%		IVe	20	13
792C2	Armstrong clay loam, 5 to 9 percent slopes, moderately eroded	9.24	11.2%		IIIe	24	27
13B	Olmitz-Zook-Humeston complex, 0 to 5 percent slopes	7.68	9.3%		IIw	78	59
179D2	Gara loam, 9 to 14 percent slopes, moderately eroded	6.15	7.4%		IVe	38	43
269B	Humeston silty clay loam, 2 to 5 percent slopes, rarely flooded	5.86	7.1%		IIIw	71	53
131C2	Pershing silty clay loam, 5 to 9 percent slopes, moderately eroded	4.05	4.9%		IIIe	62	45
S172+	Wabash silt loam, 0 to 2 percent slopes, overwash, occasionally flooded	4.03	4.9%		IIIw	16	
592C2	Mystic clay loam, 5 to 9 percent slopes, moderately eroded	3.98	4.8%		IIIe	31	20
131C	Pershing silt loam, 5 to 9 percent slopes	2.38	2.9%		IIIe	65	49
269B+	Humeston silt loam, 2 to 5 percent slopes, overwash, rarely flooded	1.26	1.5%		IIIw	71	58
179E2	Gara loam, 14 to 18 percent slopes, moderately eroded	0.33	0.4%		VIe	24	33
Weighted Average					3.11	46.8	*-

\*\*IA has updated the CSR values for each county to CSR2.

\*- CSR weighted average cannot be calculated on the current soils data, use prior data version for csr values.

\*c: Using Capabilities Class Dominant Condition Aggregation Method