

Soils Map

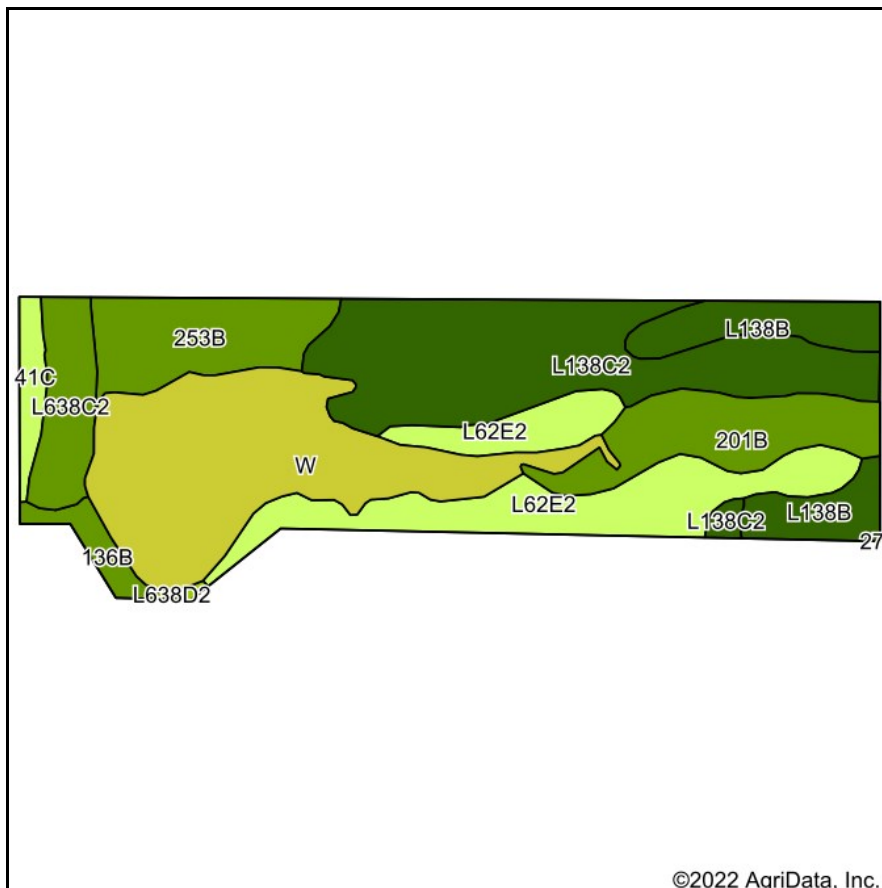

Soils data provided by USDA and NRCS.

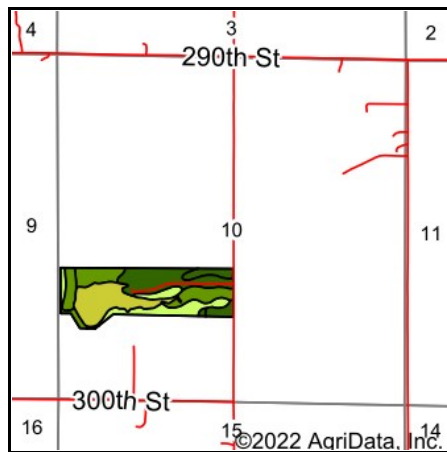

State: **Iowa**
 County: **Story**
 Location: **10-82N-23W**
 Township: **Union**
 Acres: **45.45**
 Date: **8/10/2022**



©2022 AgriData, Inc.

Area Symbol: IA169, Soil Area Version: 33

Code	Soil Description	Acres	Percent of field	CSR2 Legend	Non-Irr Class *c	CSR2**	CSR
W	Water	10.99	24.2%			0	0
L138C2	Clarion loam, Bemis moraine, 6 to 10 percent slopes, moderately eroded	10.72	23.6%		Ille	83	
L62E2	Storden loam, Bemis moraine, 10 to 22 percent slopes, moderately eroded	7.51	16.5%		Ive	32	
201B	Coland-Terril complex, 1 to 5 percent slopes	4.24	9.3%		Ilw	76	40
253B	Farrar fine sandy loam, 2 to 5 percent slopes	3.95	8.7%		Ille	76	64
L138B	Clarion loam, Bemis moraine, 2 to 6 percent slopes	3.75	8.3%		Ille	88	
L638C2	Clarion-Storden complex, Bemis moraine, 6 to 10 percent slopes, moderately eroded	2.37	5.2%		Ille	75	
41C	Sparta loamy fine sand, 5 to 9 percent slopes	0.92	2.0%		IVs	33	26
136B	Ankeny fine sandy loam, 2 to 5 percent slopes	0.88	1.9%		Ille	72	58
L638D2	Omsrud-Storden complex, Bemis moraine, 10 to 16 percent slopes, moderately eroded	0.12	0.3%		Ive	53	
Weighted Average					*-	51.9	*-

**IA has updated the CSR values for each county to CSR2.

*- CSR weighted average cannot be calculated on the current soils data, use prior data version for csr values.

*c: Using Capabilities Class Dominant Condition Aggregation Method

*- Non Irr Class weighted average cannot be calculated on the current soils data due to missing data.