

Soils Map

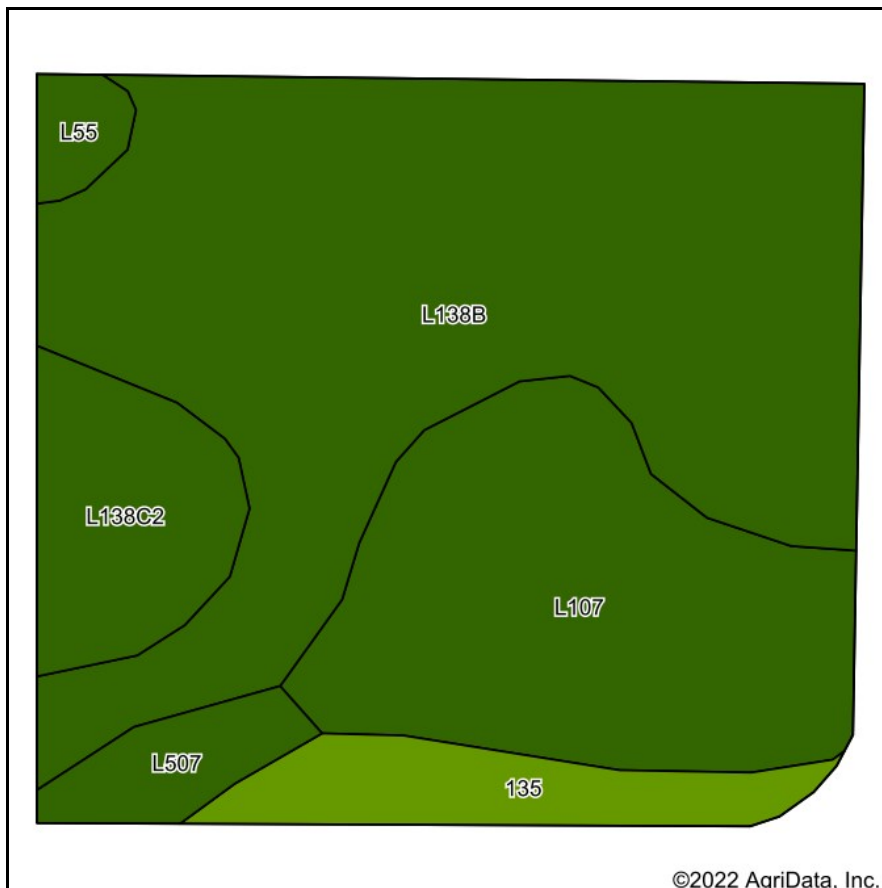

Soils data provided by USDA and NRCS.

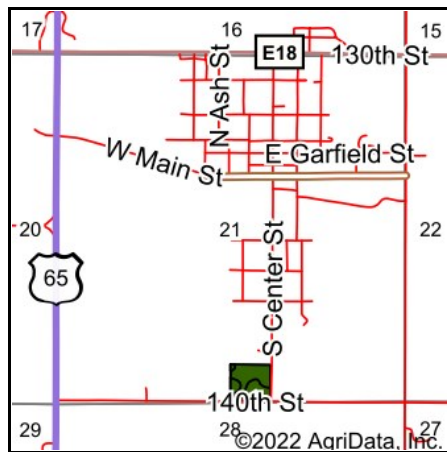

State: **Iowa**
 County: **Story**
 Location: **21-85N-21W**
 Township: **Lincoln**
 Acres: **7.59**
 Date: **6/3/2022**



Area Symbol: IA169, Soil Area Version: 33							
Code	Soil Description	Acres	Percent of field	CSR2 Legend	Non-Irr Class *c	CSR2**	CSR
L138B	Clarion loam, Bemis moraine, 2 to 6 percent slopes	4.13	54.4%		Ile	88	
L107	Webster clay loam, Bemis moraine, 0 to 2 percent slopes	1.92	25.3%		IIw	88	
L138C2	Clarion loam, Bemis moraine, 6 to 10 percent slopes, moderately eroded	0.64	8.4%		IIIle	83	
135	Coland clay loam, 0 to 2 percent slopes, occasionally flooded	0.50	6.6%		IIw	76	84
L507	Canisteo clay loam, Bemis moraine, 0 to 2 percent slopes	0.27	3.6%		IIw	87	
L55	Nicollet loam, 1 to 3 percent slopes	0.13	1.7%		Ile	91	
Weighted Average					2.07	86.8	*-

**IA has updated the CSR values for each county to CSR2.

*- CSR weighted average cannot be calculated on the current soils data, use prior data version for csr values.

*c: Using Capabilities Class Dominant Condition Aggregation Method