

W 1/4 CORNER
SEC. 26-92-29
FD. 5/8" REBAR
W/ YLLW CAP
#22875
DOC #200355

P.O.B.
EASEMENT

P.O.B.
PARCEL B

PLAT OF SURVEY

PARCEL B
31.00 TOTAL ACRES
0.00 ROAD ACRES
31.00 TAXABLE ACRES

CENTER OF SECTION
SEC. 26-92-29
SET 5/8" REBAR W/
YLLW CAP #22875

INGRESS / EGRESS PARCEL
0.54 TOTAL ACRES
0.00 ROAD ACRES
0.54 NET ACRES

AREA BREAKDOWN				
PARCEL B	TOTAL	ROAD	TAXABLE	
NW 1/4 SW 1/4	15.50	0.00	15.50	
NE 1/4 SW 1/4	15.50	0.00	15.50	
TOTALS	31.00	0.00	31.00	

PLAT OF
SURVEY
PARCEL A
11.43 ACRES
DOC #200356

SW CORNER
SEC. 26-92-29
FD. 5/8" REBAR
W/ YLLW CAP
#22875
DOC #200355

0' 200' 400'
SCALE 1" = 400'
MER # 12878

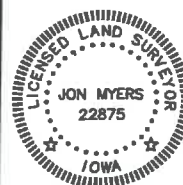

I HEREBY CERTIFY THAT THIS LAND SURVEYING DOCUMENT WAS PREPARED AND THE RELATED SURVEY WORK WAS PERFORMED BY ME OR UNDER MY DIRECT PERSONAL SUPERVISION AND THAT I AM A DULY LICENSED LAND SURVEYOR UNDER THE LAWS OF THE STATE OF IOWA.

JON MYERS
LICENSE NUMBER 22875
MY LICENSE RENEWAL DATE IS DECEMBER 31, 2022
PAGES COVERED BY THIS SEAL 2

DATE OF FIELD WORK
APRIL 29, 2022

SPACE RESERVED FOR RECORDING INFORMATION

INDEX LEGEND

SECTION: 26
TOWNSHIP: 92 N
RANGE: 29 W

COUNTY: HUMBOLDT

LOCATION:

SURVEY OF PARCEL B MEASURING
OUT THE NORTH 31 ACRES OF THE
SW 1/4 OF 26-92-29 HUMBOLDT
COUNTY, IOWA

26-92-29

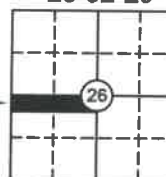

REQUESTED BY: DARYL VOSBERG
PROPRIETOR: TROY PETERSON, ROY PETERSON, SONYA COLVIN,
HEIDY VOSBERG, LORY BOWERMAN

LEGEND

SECTION CORNER FOUND

SECTION CORNER SET

PROPERTY CORNERS SET

5/8"x24" REBAR W/ YLLW

PLASTIC CAP #22875

MAGNAIL W/ WASHER #22875

PROPERTY CORNERS FOUND
5/8" REBAR OR AS NOTED

MAGNAIL
POINT OF BEGINNING
RECORD DIMENSIONS
MEASURED DIMENSIONS
FENCE IN PLACE

P.O.B.
(100.00')
100.00'
X

DESCRIPTION: PARCEL B

A PARCEL OF LAND BEING A PORTION OF THE SOUTHWEST QUARTER (SW1/4) OF SECTION TWENTY-SIX (26), TOWNSHIP NINETY-TWO (92) NORTH, RANGE TWENTY-NINE (29) WEST OF THE 5TH P.M., HUMBOLDT COUNTY, IOWA AND BEING MORE PARTICULARLY DESCRIBED AS FOLLOWS:

BEGINNING AT THE WEST QUARTER CORNER OF SAID SECTION 26; THENCE ON AN ASSUMED BEARING OF SOUTH 89°50'17" EAST 2615.49 FEET, ALONG THE NORTH LINE OF SAID SW1/4 TO THE CENTER OF SAID SECTION 26; THENCE LEAVING SAID NORTH LINE, SOUTH 00°48'42" EAST 516.04 FEET, ALONG THE EAST LINE OF SAID SW1/4; THENCE LEAVING SAID EAST LINE, NORTH 89°50'20" WEST 2618.62 FEET TO THE WEST LINE OF SAID SW1/4; THENCE NORTH 00°27'52" WEST 516.04 FEET, ALONG SAID WEST LINE, TO THE POINT OF BEGINNING.

PARCEL CONTAINS 31.00 ACRES AND IS SUBJECT TO EASEMENTS OF RECORD. NOTE: FOR THE PURPOSE OF THIS SURVEY, THE NORTH LINE OF THE SOUTHWEST QUARTER OF 26-92-29 IS ASSUMED TO BEAR SOUTH 89°50'17" EAST.

DESCRIPTION: INGRESS/EGRESS EASEMENT

A FORTY (40) FOOT EASEMENT FOR INGRESS AND EGRESS OVER AND ACROSS THAT PORTION OF THE NORTHWEST QUARTER OF THE SOUTHWEST QUARTER (NW1/4 SW1/4) OF SECTION TWENTY-SIX (26), TOWNSHIP NINETY-TWO (92) NORTH, RANGE TWENTY-NINE (29) WEST OF THE 5TH P.M., HUMBOLDT COUNTY, IOWA AND BEING MORE PARTICULARLY DESCRIBED AS FOLLOWS:

COMMENCING AT THE WEST QUARTER CORNER OF SAID SECTION 26; THENCE SOUTH 00°27'52" EAST 516.04 FEET, ALONG THE WEST LINE OF SAID SOUTHWEST QUARTER (SW1/4) TO THE POINT OF BEGINNING; THENCE CONTINUING ALONG SAID WEST LINE, SOUTH 00°27'52" EAST 578.88 FEET TO THE NORTH RIGHT OF WAY LINE OF THE FORMER CHICAGO AND NORTHWESTERN RAILWAY COMPANY, CURRENTLY THE NORTH LINE OF THE HUMBOLDT COUNTY CONSERVATION BOARD TRAIL; THENCE SOUTH 59°57'46" EAST 46.42 FEET ALONG SAID NORTH LINE; THENCE LEAVING SAID NORTH LINE, NORTH 00°27'52" WEST 602.01 FEET TO THE SOUTH LINE OF PARCEL B; THENCE NORTH 89°50'20" WEST 40.00 FEET, ALONG THE SOUTH LINE OF PARCEL B TO THE POINT OF BEGINNING.

PARCEL CONTAINS 0.54 ACRES (23,618 Sq Ft) AND IS SUBJECT TO EASEMENTS OF RECORD. NOTE: FOR THE PURPOSE OF THIS SURVEY, THE NORTH LINE OF THE SOUTHWEST QUARTER OF 26-92-29 IS ASSUMED TO BEAR SOUTH 89°50'17" EAST.