

# Soils Map

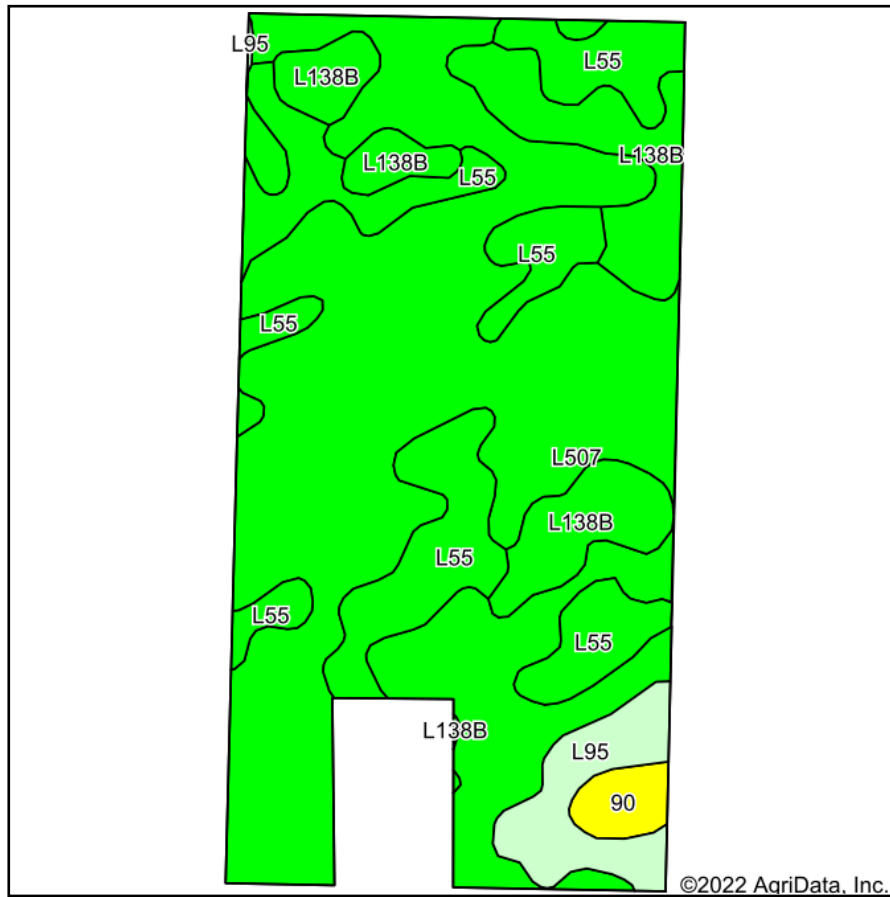

Soils data provided by USDA and NRCS.

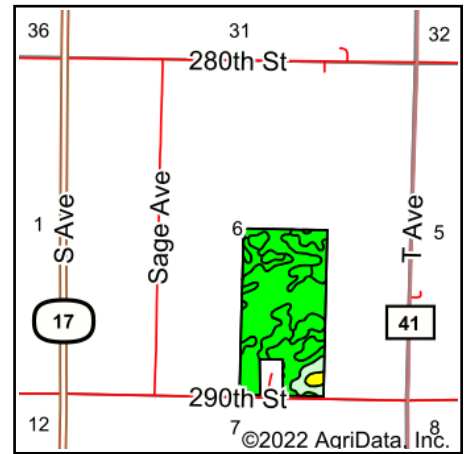

State: **Iowa**  
 County: **Boone**  
 Location: **6-82N-25W**  
 Township: **Garden**  
 Acres: **74.5**  
 Date: **2/28/2022**



Area Symbol: IA015, Soil Area Version: 29

Code	Soil Description	Acres	Percent of field	CSR2 Legend	Non-Irr Class *c	CSR2**	CSR
L507	Canisteo clay loam, Bemis moraine, 0 to 2 percent slopes	44.56	59.8%		IIw	87	
L55	Nicollet loam, 1 to 3 percent slopes	15.19	20.4%		Ie	91	
L138B	Clarion loam, Bemis moraine, 2 to 6 percent slopes	9.76	13.1%		Ile	88	
L95	Harps clay loam, Bemis moraine, 0 to 2 percent slopes	3.73	5.0%		IIw	75	
90	Okoboji mucky silt loam, 0 to 1 percent slopes	1.26	1.7%		IIIw	56	61
Weighted Average					1.81	86.8	*-

\*\*IA has updated the CSR values for each county to CSR2.

\*- CSR weighted average cannot be calculated on the current soils data, use prior data version for csr values.

\*c: Using Capabilities Class Dominant Condition Aggregation Method

Soils data provided by USDA and NRCS.