

Soils Map

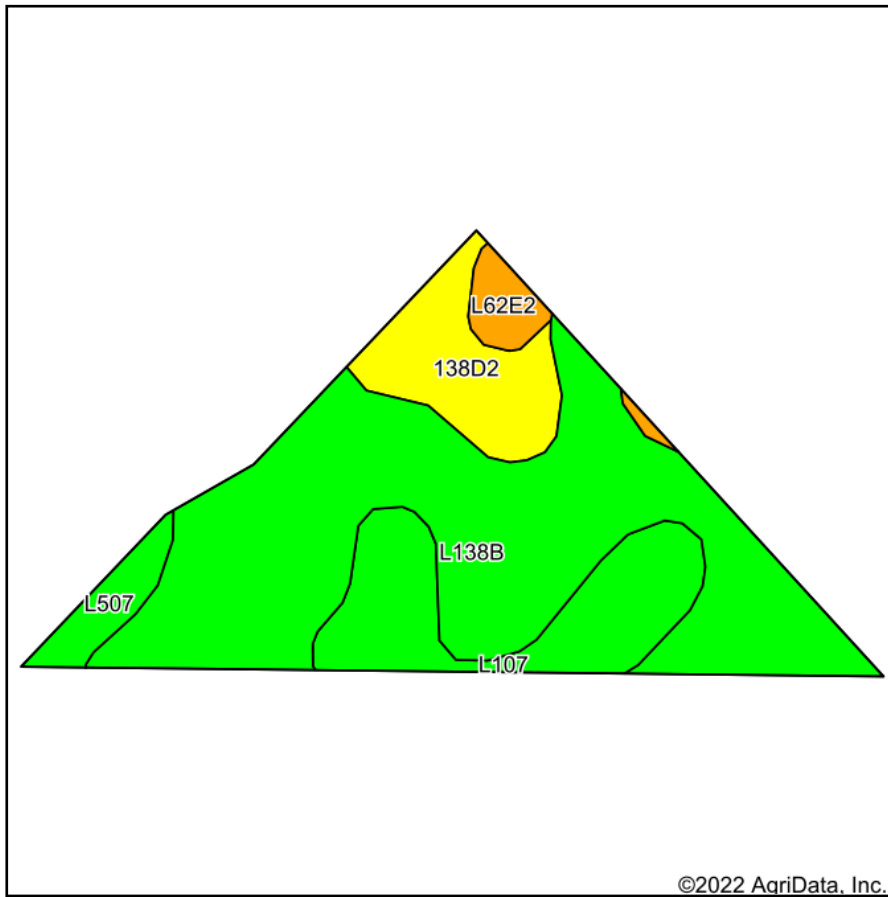

Soils data provided by USDA and NRCS.

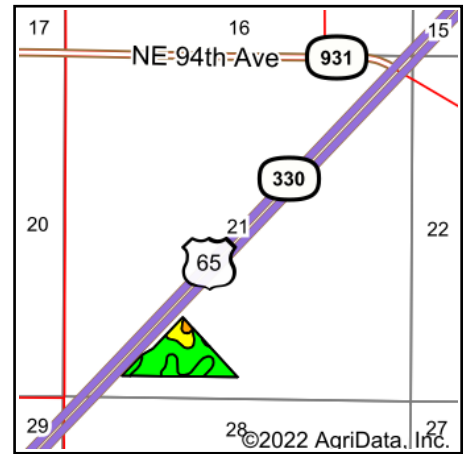

State: **Iowa**
 County: **Polk**
 Location: **21-80N-22W**
 Township: **Franklin**
 Acres: **18.35**
 Date: **1/30/2022**



Area Symbol: IA153, Soil Area Version: 23							
Code	Soil Description	Acres	Percent of field	CSR2 Legend	Non-Irr Class *c	CSR2**	CSR
L138B	Clarion loam, Bemis moraine, 2 to 6 percent slopes	11.54	62.9%		Ile	88	
L107	Webster clay loam, Bemis moraine, 0 to 2 percent slopes	3.24	17.7%		Ilw	88	
138D2	Clarion loam, 9 to 14 percent slopes, moderately eroded	2.23	12.2%		IIIe	56	58
L507	Canisteo clay loam, Bemis moraine, 0 to 2 percent slopes	0.74	4.0%		Ilw	87	
L62E2	Storden loam, Bemis moraine, 10 to 22 percent slopes, moderately eroded	0.60	3.3%		IVe	32	
Weighted Average					2.19	82.2	*-

**IA has updated the CSR values for each county to CSR2.

*- CSR weighted average cannot be calculated on the current soils data, use prior data version for csr values.

*c: Using Capabilities Class Dominant Condition Aggregation Method

Soils data provided by USDA and NRCS.